

# RUH Radial Lead Type

series

- Ultra-High Voltage, High Capacitance
- Low ESR, High ripple current
- Load life of 3,000h at 105°C

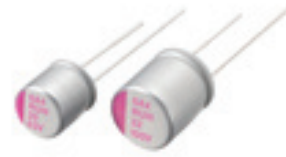

## SPECIFICATIONS

Items	Characteristics	
Temperature range	-55 to +105°C	
Rated voltage range	63 to 125Vdc	
Capacitance range	8.2 to 120μF	
Capacitance tolerance	±20% [M] (at 20°C, 120Hz)	
Tangent of loss angle	Less than or equal to the value of Standard Ratings (at 20°C, 120Hz)	
Leakage current	Less than or equal to the value of Standard Ratings (at 20°C, after 2 minutes)	
ESR	Less than or equal to the value of Standard Ratings	
Characteristics of impedance	Z <sub>+105°C</sub> /Z <sub>+20°C</sub> ≤ 1.25, Z <sub>-55°C</sub> /Z <sub>+20°C</sub> ≤ 1.25 at 100kHz	
Endurance	105°C, 3,000 hrs at rated voltage	
	Appearance	No significant damage
	Capacitance change	Within±20% of the initial value
	Tangent of loss angle (tanδ)	≤150% of the initial specified value
	ESR(mΩ)	≤150% of the initial specified value
	Leakage current	≤The initial specified value
Damp Heat (Steady State)	60°C, 90 to 95% RH, 1,000 hrs, No-applied Voltage	
	Appearance	No significant damage
	Capacitance change	Within±20% of the initial value
	Tangent of loss angle (tanδ)	≤150% of the initial specified value
	ESR(mΩ)	≤150% of the initial specified value
	Leakage current	≤The initial specified value
Resistance to soldering heat	Flow method (260±5°C, 10s)	
	Appearance	No significant damage
	Capacitance change	Within±10% of the initial value
	Tangent of loss angle (tanδ)	≤130% of the initial specified value
	ESR(mΩ)	≤130% of the initial specified value
	Leakage current	≤The initial specified value

\*In case of some problems for measured values, measure after applying rated voltage for 120 minutes at 105°C

## SIZE LIST

(unit : mm)

μF	RV(SV)	63 (72.4)	80 (92)	100 (115)	125 (143)
8.2		6.3 x 6			
10		8 x 7		8 x 11.5	8 x 11.5
12			8 x 11.5		
15		8 x 7		8 x 11.5	8 x 11.5
18				10 x 11.5	
22			10 x 11.5	10 x 11.5	
27		8 x 11.5	10 x 11.5		
33		8 x 11.5			8 x 11.5
39		8 x 11.5		10 x 11.5	
47		10 x 11.5		10 x 11.5	
56		10 x 11.5			
68			10 x 11.5	10 x 11.5	
82			10 x 11.5		
120		10 x 11.5			

\*RV : Rated Voltage [V] SV : Surge Voltage [V] (at room temperature)

## MARKING AND DIMENSIONS

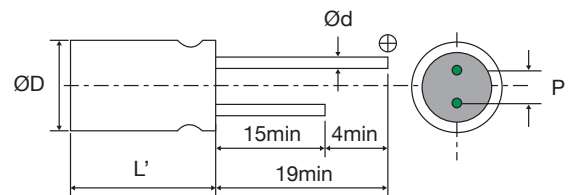

(unit : mm)

Size	ØD±0.5	L	L'	P±0.5	Ø d
6.3 x 6	6.3	6.0	L max.	2.5	0.45
8 x 7	8.0	7.0	L max.	3.5	0.45
8 x 11.5	8.0	11.5	L+1.0max.	3.5	0.60
10 x 11.5	10.0	11.5	L+1.0max.	5.0	0.60

# Conductive Polymer Aluminum Capacitors

## STANDARD RATINGS

Rated Voltage [Vdc]	Rated Capacitance [ $\mu$ F]	Size $\Phi$ D x L [mm]	ESR (20°C, 100kHz) [m $\Omega$ ] [max.]	Rated Ripple Current (105°C, 100kHz) [mA rms]	Tangent of Loss Angel [max.]	Leakage Current [ $\mu$ A, max.]	Part Number
63	8.2	6.3 x 6	55	1200	0.12	103	63RUH8R2MC6
	10	8 x 7	50	1400	0.12	126	63RUH10MD7
	15	8 x 7	50	1500	0.12	189	63RUH15MD7
	27	8 x 11.5	35	2800	0.12	340	63RUH27MD11
	33	8 x 11.5	30	3000	0.12	416	63RUH33MD11
	39	8 x 11.5	29	3400	0.12	491	63RUH39MD11
	47	10 x 11.5	29	3300	0.12	592	63RUH47ME11
	56	10 x 11.5	28	3400	0.12	706	63RUH56ME11
	120	10 x 11.5	25	4000	0.12	1512	63RUH120ME11
80	12	8 x 11.5	38	1900	0.12	192	80RUH12MD11
	22	10 x 11.5	35	2300	0.12	352	80RUH22ME11
	27	10 x 11.5	35	2400	0.12	432	80RUH27ME11
	68	10 x 11.5	30	3000	0.12	1088	80RUH68ME11
	82	10 x 11.5	30	3200	0.12	1312	80RUH82ME11
100	10	8 x 11.5	42	1800	0.12	200	100RUH10MD11
	15	8 x 11.5	40	2000	0.12	300	100RUH15MD11
	18	10 x 11.5	38	2200	0.12	360	100RUH18ME11
	22	10 x 11.5	38	2300	0.12	440	100RUH22ME11
	39	10 x 11.5	35	2500	0.12	780	100RUH39ME11
	47	10 x 11.5	35	2600	0.12	940	100RUH47ME11
	68	10 x 11.5	30	2800	0.12	1360	100RUH68ME11
125	10	8 x 11.5	50	1500	0.12	250	125RUH10MD11
	15	8 x 11.5	50	1800	0.12	375	125RUH15MD11
	33	10 x 11.5	40	2000	0.12	825	125RUH33ME11

